

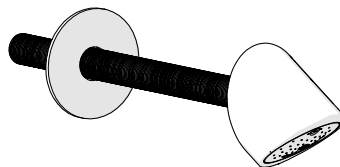

Safe-Cell® Manual Prison Tapware

PRODUCT CODES:

- 40698



SPECIFICATIONS

- The Safe-Cell® Vandal Resistant Shower Rose 65 provides both anti-vandalism and anti-ligature features.
- This shower is used extensively in high risk, high security applications such as prisons, correctional facilities, and detention centres.
- Designed for maximum protection against vandalism.
- The Safe-Cell® Vandal Resistant Shower Rose 65 is made from heavy duty components and come complete with special tamper-resistant screws.
- For use with high pressure plumbing systems between 150 & 500kPa.
- Special consideration may be required when used with low water pressure systems and components.
- Designed to suit wall thickness up to 275mm and Anti-ligature.

IMPORTANT: All Safe-Cell® Vandal Resistant Shower Roses are tested in accordance with AS/NZS 3662 and leave our premises in good working order.

TECHNICAL DATA

Inlet	½" BSP - Male	
Outlet	Shower Rose	
Headwork	N/A	
Working Pressure Range (kPa)	Min	150
	Max	500
Working Temperature Range (°C)	Min	5
	Max	85
Nominal Flow Rate (LPM)	6.5	
Finish	Chrome	

NOTE: Galvin Specialised continually strive to improve their products. Specifications may change without notice.

PRE-INSTALLATION

MOUNTING DETAILS – HOLE CENTRES

- The rough in details have been provided to show correct fitment of the Vandal Resistant Shower unit (see side image).
- Drill hole Ø11mm minimum 15mm deep required.
- Recommended installation height above floor level is 2 meters (6'6").

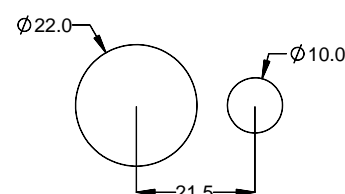

TOOLS REQUIRED

- Thread tape or Sealant
- Hex key
- Power Drill

INSTALLATION

IMPORTANT: Galvin Specialised products must be installed in accordance with these installation instructions and in accordance with AS/NZS 3500, the PCA and your local regulatory requirements. Water and/or electrical supply conditions must also comply to the applicable National and/or State standards. Failing to comply with these provisions shall void the product warranty and may affect the performance of the product.

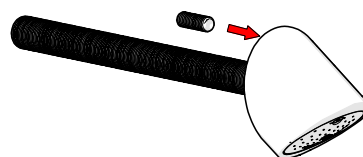
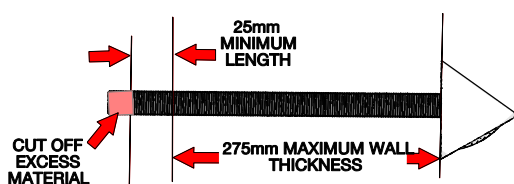

1. Measure extension nipple

- Insert shower body through the $\varnothing 22\text{mm}$ hole in the wall.
- Ensuring a minimum of 25mm is protruding from the wall, mark where to remove excess material.
- Remove shower body from wall, cut where marked, removing any burrs.

2. Fit grub screw

- Fit supplied $3/8"$ Whitworth grub screw into the tapped hole on the back of the shower body and tighten.

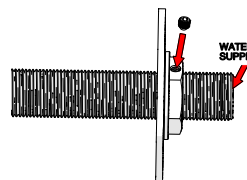
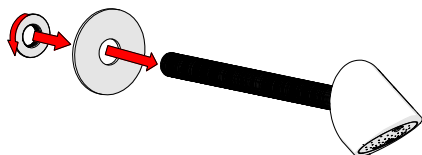

3. Fit shower body

- Re-insert the shower body through the wall and secure using the large galvanised washer and flanged back nut.
- Ensure anti-rotation grubs screw locates into drill hole.

4. Fit the grub screw

- Fit the supplied grub screw into the flanged back nut and lock securely.
- Connect water supply, ensuring to apply thread tape or sealant to create a water tight seal.

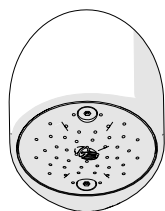

5. Checking & Testing

- Turn on water supply, inspect the tap and check for any leaks.

Note: Never operate without a flow restrictor, as Safe-cell® Vandal resistant shower rose will deliver full mains pressure with unrestricted flow.



TROUBLESHOOTING

PROBLEM	CAUSE	RECTIFICATION
Shower is dripping water	Head-works are worn or damaged	Remove and inspect the head-works, remove debris and/or replace head parts if damaged
Inconsistent flow	Blocked flow restrictor	Remove flow regulator from body and remove debris. Install an inline strainer to stop further blockages.
Leak from behind body	Insuficent sealant	Apply more sealant
Water is not flowing from tap	Water is turned off	Turn on water
Rate of flow inadequate	The flow restrictor may not be satisfactory due to inadequate supply pressure	Remove flow restrictor and replace with a flow restrictor of differencnt capacity to suit (available from Galvin Specialised)

WARRANTY

The warranty set forth herein is given expressly and is the only warranty given by the Galvin Engineering Pty Ltd. With respect to the product, Galvin Engineering Pty Ltd makes no other warranties, express or implied. Galvin Engineering Pty. Ltd. hereby specifically disclaims all other warranties, express or implied, including but not limited to the implied warranties of merchantability and fitness for a particular purpose.

Galvin Engineering Pty Ltd products are covered under our manufacturer's warranty available for download from www.galvinengineering.com.au Galvin Engineering Pty Ltd expressly warrants that the product is free from operational defects in workmanship and materials for the warranty period as shown on the schedule in the manufacturer's warranty. During the warranty period, Galvin Engineering will replace or repair any defective products manufactured by Galvin Engineering without charge, so long as the terms of the Manufacturer's warranty are complied with.

The remedy described in the first paragraph of this warranty shall constitute the sole and exclusive remedy for breach of warranty, and Galvin Engineering Pty Ltd shall not be responsible for any incidental, special or consequential damages, including without limitation, lost profits or the cost of repairing or replacing other property which is damaged if this product does not work properly, other costs resulting from labour charges, delays, vandalism, negligence, fouling caused by foreign material, damage from adverse water conditions, chemical, electrical or any other circumstances over which Galvin Engineering has no control. This warranty shall be invalidated by any abuse, misuse, misapplication, improper installation or improper maintenance or alteration of the product.

